



HD BRUSHLESS

DelStar® SERIES 400

1400-40292

28 Volts, 550 Amps

Drop In Replacement for:

CE Niehoff C840D and C803D

Features:

- Lighter & smaller than all the competitor's units in this class
- A perfect drop-in for cradle mount applications
- Modular design up to 65% less time required to service or rebuild the unit

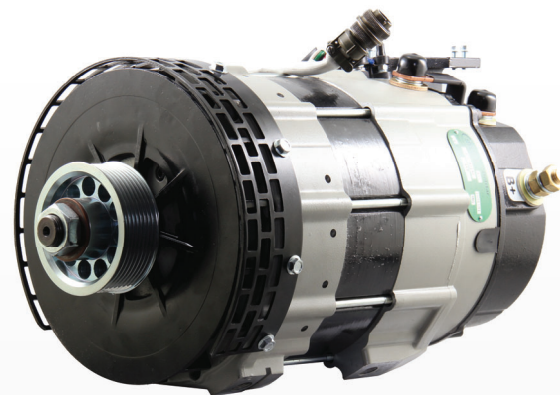

*Shown without regulator
Pictured without voltage regulator (Customer must use existing voltage regulator).

PRODUCT SPECIFICATIONS

Part Number	1400-40292
System Voltage	24V
Rated Output	550A
Output @ 2000 rpm	325A
Ground	Negative
Mounting	Cradle
Rotation	Bidirectional
Temperature Limits	Low - 40°C / -40°F High 125° C / 257° F
Speed Limits	7000 RPM continuous 8000 RPM intermittent
Coating	Corrosion-Resistant E-Coated
Weight	42.5 kg/ 94 Lbs.
Regulator	Top Mounted

PERFORMANCE CURVES

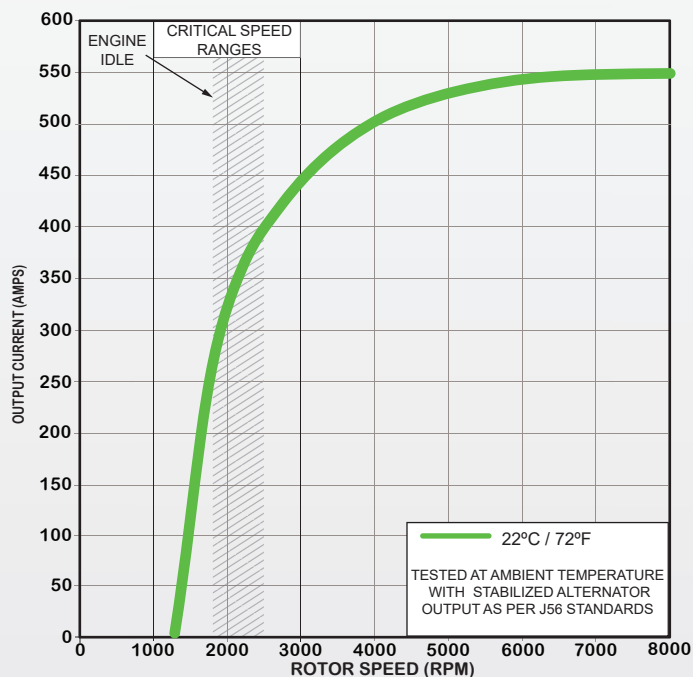

Note:

This DelStar 1400-40292 alternator meets the marine requirements for Ignition Protection on gas or diesel engines of ISO 8846, USCG, stated in Title 33 CFR 183.410, SAE J1171 and International CE Standards.

ALTERNATORS

OUTLINE

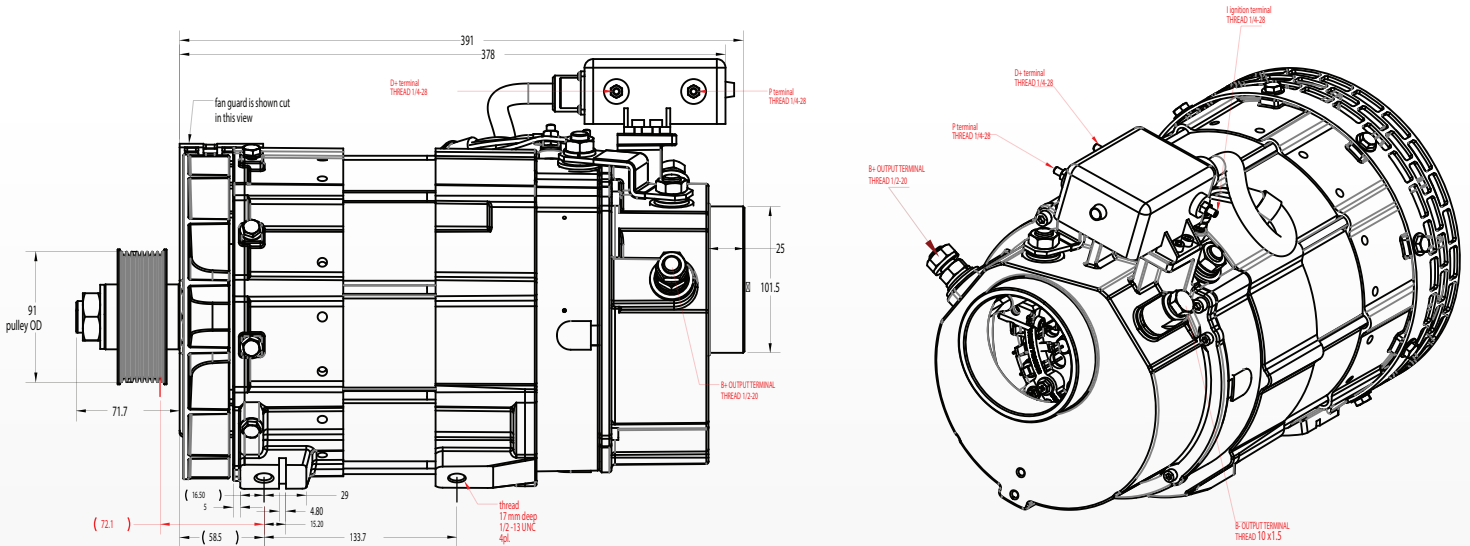

Dimensions are listed in mm

1400-40292

28 Volts, 550 Amps

CONNECTIONS

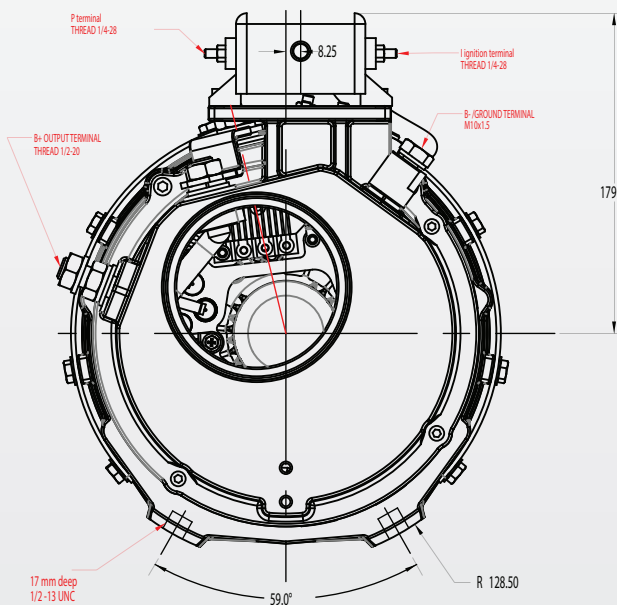

ELECTRICAL SCHEMATIC

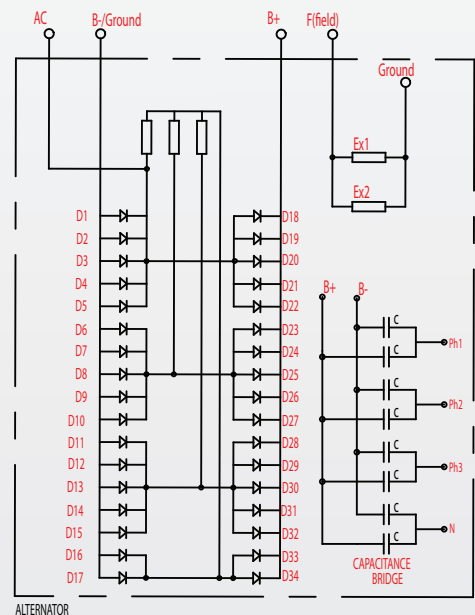

CANADA & EXPORT SALES

Dixie Electric
517 Basaltic Road
Concord, ON
Canada L4K 4W8

Tel: 905-879-0533 | 800-461-5799
Fax: 905-879-0532
E-Mail: sales@dixie-electric.com
www.dixie-electric.com



U.S.A. SALES

Dixie Electric Inc.
5600 Pioneer Creek Drive, Suite D
Maple Plain, MN 55359
U.S.A.

Tel: 763-475-6629 | 800-478-0608
Fax: 763-475-6635 | 800-392-8719
E-Mail: mn.sales@dixie-electric.com
www.dixie-electric.us